

INVESTMENT OPPORTUNITY

MULTI-FAMILY DEVELOPMENT SITE

96 UNITS + COMMERCIAL

Development Land - For Sale

137 Victoria Street, Digby, NS B0V 1A0

kww COMMERCIAL
ADVISORS

TABLE OF CONTENTS

137 VICTORIA STREET

TOM GERARD, CCIM, SIOR

COMMERCIAL PRACTICE MANAGER

O: (902) 407-2489

C: (902) 830-1318

tomgerard@kwcommercial.com

Nova Scotia

PAUL PETTIPAS, LLB, MICP

COMMERCIAL REAL ESTATE ADVISOR

O: 902-497-9636

paul.pettipas@kw.com

Location Maps	3
Property Summary	4
Property Photos	5
North Elevation	6
East & West Elevations	7
Parking Level + 1st Floor Plan	8
Parking Levels 2 - 4	9
Disclaimer	10

KW COMMERCIAL ADVISORS
1160 Bedford Highway, Suite 100
Bedford, NS B4A 1C1



Each Office Independently Owned and Operated

LOCATION MAPS

137 VICTORIA STREET



EXECUTIVE SUMMARY

137 VICTORIA STREET

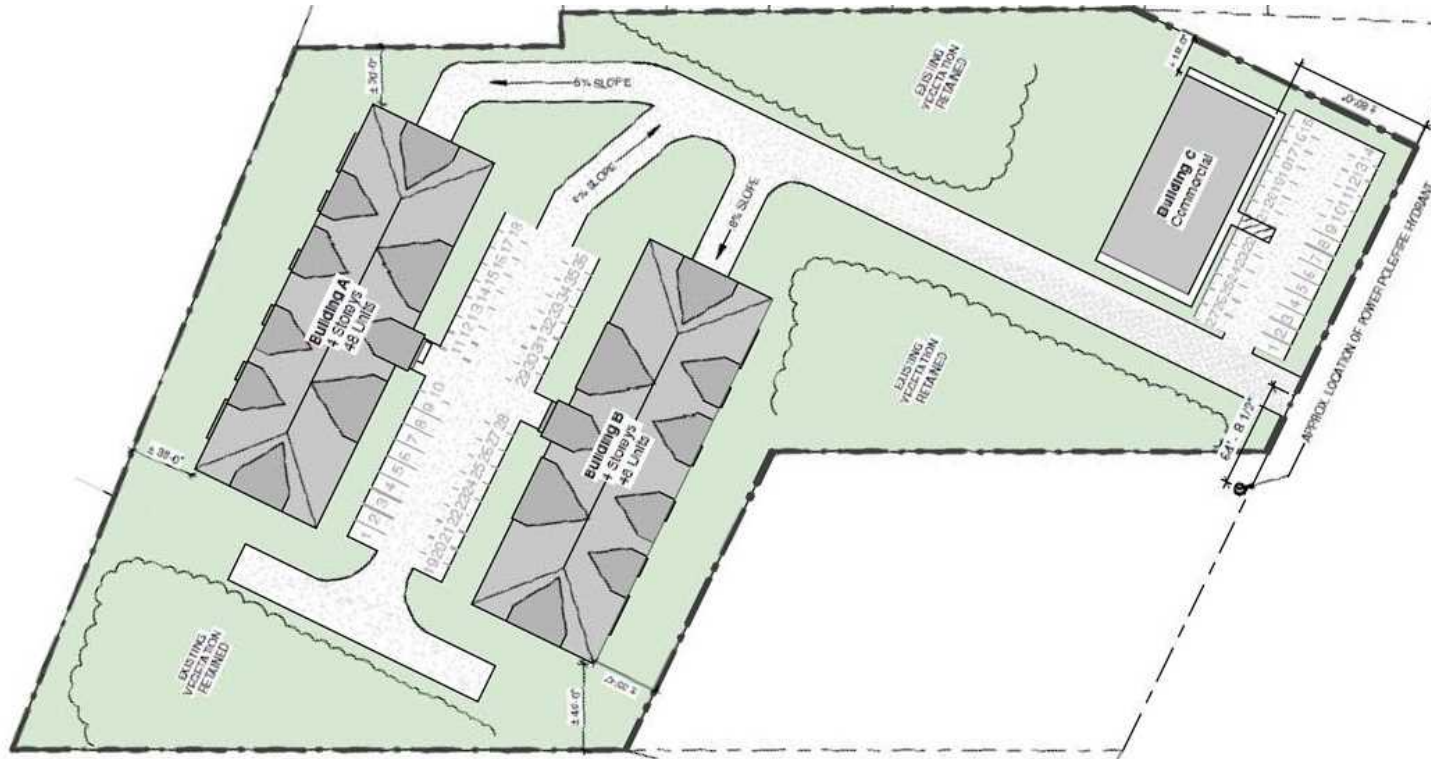

Property Summary

Building GBA:	80,708 SF / Building
Lot Size:	243,309 SF
Zoning:	Development Agreement
Assessed Owner:	Robin Ghosn
Assessed Value:	\$62,500
List Price:	\$995,000

Property Overview

Development lot, treed, sloping to Victoria Street
Municipal water/sewer
151 Surface / Underground parking

Location Overview

The property is located at 137 Victoria Street, Digby and is adjacent to the the local RCMP Detachment. The location offers excellent accessibility to Highway 101, and is within walking distance of the Digby General Hospital as well as other amenities.

PROPERTY PHOTOS

137 VICTORIA STREET

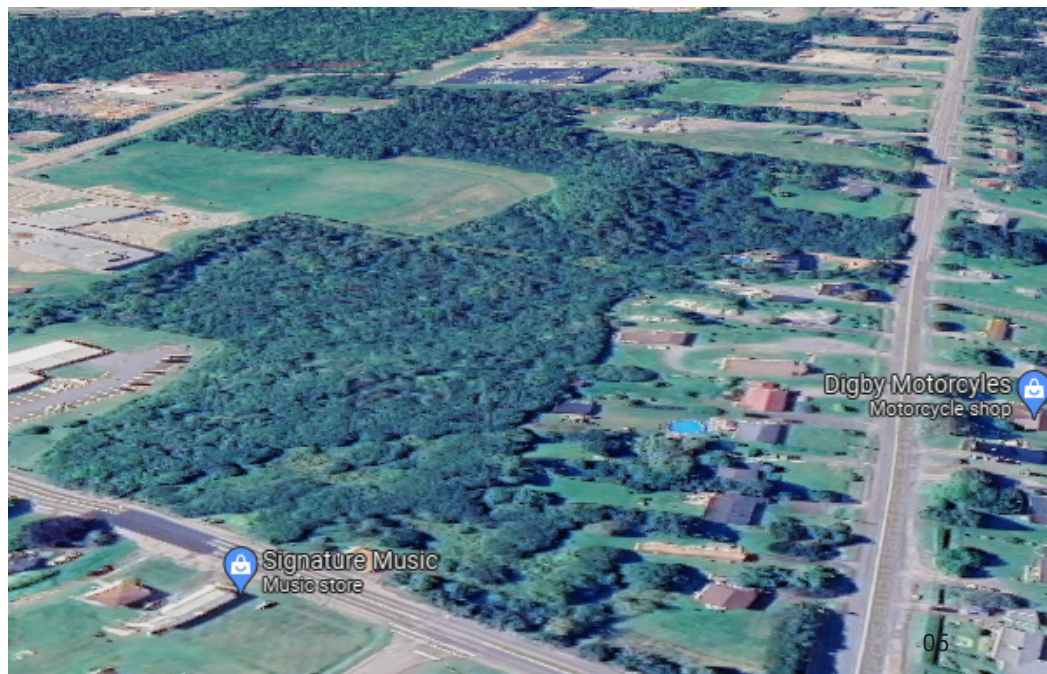

NORTH ELEVATION

137 VICTORIA STREET



DIGBY DEVELOPMENT VICTORIA STREET, DIGBY NS	North Elevation	Project No: 2022-10 Scale: 1/16" = 1'-0" Date: 2022-09-29 12:00:35 PM			D8
--	-----------------	---	---	---	----

EAST & WEST ELEVATIONS

137 VICTORIA STREET



1 East Elevation
1/16" = 1'-0"



2 West Elevation
1/16" = 1'-0"

DIGBY DEVELOPMENT
VICTORIA STREET, DIGBY NS

East & West Elevation

Project No: 2022-10
Scale: 1/16" = 1'-0"
Date: 2022-09-29
12:00:36 PM



WM FARES
ARCHITECTS

D9

PARKING LEVEL + 1ST FLOOR PLAN

137 VICTORIA STREET



PARKING LEVELS 2 - 4

137 VICTORIA STREET



DISCLAIMER

137 VICTORIA STREET

All materials and information received or derived from KW Commercial its directors, officers, agents, advisors, affiliates and/or any third party sources are provided without representation or warranty as to completeness, veracity, or accuracy, condition of the property, compliance or lack of compliance with applicable governmental requirements, developability or suitability, financial performance of the property, projected financial performance of the property for any party's intended use or any and all other matters.

Neither KW Commercial its directors, officers, agents, advisors, or affiliates makes any representation or warranty, express or implied, as to accuracy or completeness of the materials or information provided, derived, or received. Materials and information from any source, whether written or verbal, that may be furnished for review are not a substitute for a party's active conduct of its own due diligence to determine these and other matters of significance to such party. KW Commercial will not investigate or verify any such matters or conduct due diligence for a party unless otherwise agreed in writing.

EACH PARTY SHALL CONDUCT ITS OWN INDEPENDENT INVESTIGATION AND DUE DILIGENCE.

Any party contemplating or under contract or in escrow for a transaction is urged to verify all information and to conduct their own inspections and investigations including through appropriate third-party independent professionals selected by such party. All financial data should be verified by the party including by obtaining and reading applicable documents and reports and consulting appropriate independent professionals. KW Commercial makes no warranties and/or representations regarding the veracity, completeness, or relevance of any financial data or assumptions. KW Commercial does not serve as a financial advisor to any party regarding any proposed transaction.

All data and assumptions regarding financial performance, including that used for financial modeling purposes, may differ from actual data or performance. Any estimates of market rents and/or projected rents that may be provided to a party do not necessarily mean that rents can be established at or increased to that level. Parties must evaluate any applicable contractual and governmental limitations as well as market conditions, vacancy factors and other issues in order to determine rents from or for the property. Legal questions should be discussed by the party with an attorney. Tax questions should be discussed by the party with a certified public accountant or tax attorney. Title questions should be discussed by the party with a title officer or attorney. Questions regarding the condition of the property and whether the property complies with applicable governmental requirements should be discussed by the party with appropriate engineers, architects, contractors, other consultants, and governmental agencies. All properties and services are marketed by KW Commercial in compliance with all applicable fair housing and equal opportunity laws.

KW COMMERCIAL ADVISORS

1160 Bedford Highway, Suite 100
Bedford, NS B4A 1C1



Each Office Independently Owned and Operated

PRESENTED BY:

TOM GERARD, CCIM, SIOR

Commercial Practice Manager
O: (902) 407-2489
C: (902) 830-1318
tomgerard@kwcommercial.com
Nova Scotia

PAUL PETTIPAS, LLB, MICP

Commercial Real Estate Advisor
O: 902-497-9636
paul.pettipas@kw.com

The calculations and data presented are deemed to be accurate, but not guaranteed. They are intended for the purpose of illustrative projections and analysis. The information provided is not intended to replace or serve as substitute for any legal, accounting, investment, real estate, tax or other professional advice, consultation or service. The user of this software should consult with a professional in the respective legal, accounting, tax or other professional area before making any decisions.