

DEVELOPMENT LAND FOR SALE

Lot 15 Main Street

Lot 15 Main Street, Dartmouth,

Development Land

Garden Patch
Garden center

kww COMMERCIAL
ADVISORS

EXECUTIVE SUMMARY

LOT 15 MAIN STREET



OFFERING SUMMARY

CIVIC ADDRESS:	Lot 15 Main Street
PROPERTY TYPE:	Commercial Land
PID#:	41463415
LOT SIZE:	1.05 Acres
MUNICIPAL SERVICES:	Hydro, telephone, sewer, water, police and fire protection
ZONING:	C-4 Highway Commercial
ASSESSED OWNER:	Hillsboro Holding Inc.
ASSESSED VALUE:	\$347,300 (2022 Commercial Taxable)
LIST PRICE:	\$749,000 (\$16.57 PSF)

SITE DIMENSIONS:

- Main Street Frontage: 208'
- Hillsboro Drive Frontage: 243'
- Southern Boundary: 163'
- Western Boundary: 202'

PROPERTY OVERVIEW

- Flat corner lot
- 50,000 Daily traffic count
- C-4 Highway Commercial Zone
- Property comes with an approved Wetland Alteration Certificate

LOCATION & HIGHLIGHTS

LOT 15 MAIN STREET

LOCATION OVERVIEW

Highly visible and easily accessible on the main thoroughfare of Main Street in Dartmouth, this mixed-use commercial lot is in close proximity to the other Dartmouth bedroom community nodes of Westphal, Woodlawn, Cole Harbour and Porters Lake.

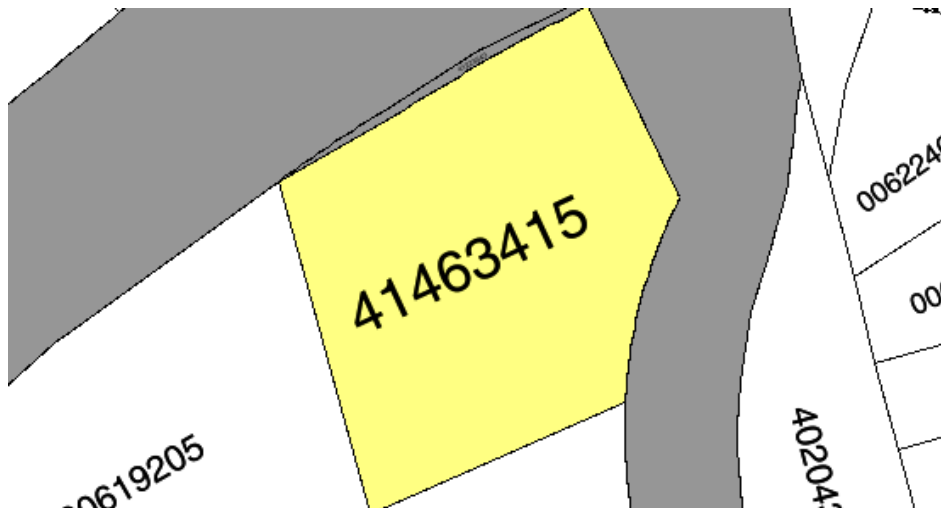

BUSINESS MAP

LOT 15 MAIN STREET



PROPERTY PHOTOS

LOT 15 MAIN STREET



PAUL PETTIPAS BIO

LOT 15 MAIN STREET

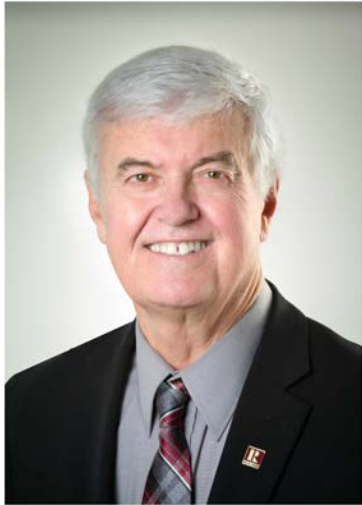

PAUL PETTIPAS, LLB, MiCP
COMMERCIAL REAL ESTATE ADVISOR
KW COMMERCIAL ADVISORS

902-497-9636 | PAUL.PETTIPAS@KW.COM

Paul Pettipas was a builder/developer for 30 years before becoming CEO of the Nova Scotia Home Builders' Association and R-2000 regional manager for Nova Scotia in 1999. Paul has served on numerous boards including Habitat for Humanity and Nova Scotia Construction Safety Association.

Paul was the 1998 Nova Scotia Home Builders' Association 'Builder of the Year' and 2002 recipient of the Dave Stupart Award of Honour as the Canadian Home Builders' Association Chief Executive Officer of the Year.

Specialties include: Land Sales, Single and Multi-tenant Industrial Buildings, Not for Profit, Institutional Properties and Development Sites.

ADVISOR EXPERTISE

Investment Sales
Industrial Occupier Services
Real Estate Consulting

EDUCATION, MEMBERSHIPS AND AWARDS

1967 – Bachelor of Commerce, Saint Mary's University
1973 – Dalhousie Law School
1974 – Admitted to the Nova Scotia Bar

DISCLAIMER

LOT 15 MAIN STREET

All materials and information received or derived from KW Commercial its directors, officers, agents, advisors, affiliates and/or any third party sources are provided without representation or warranty as to completeness, veracity, or accuracy, condition of the property, compliance or lack of compliance with applicable governmental requirements, developability or suitability, financial performance of the property, projected financial performance of the property for any party's intended use or any and all other matters.

Neither KW Commercial its directors, officers, agents, advisors, or affiliates makes any representation or warranty, express or implied, as to accuracy or completeness of the any materials or information provided, derived, or received. Materials and information from any source, whether written or verbal, that may be furnished for review are not a substitute for a party's active conduct of its own due diligence to determine these and other matters of significance to such party. KW Commercial will not investigate or verify any such matters or conduct due diligence for a party unless otherwise agreed in writing.

EACH PARTY SHALL CONDUCT ITS OWN INDEPENDENT INVESTIGATION AND DUE DILIGENCE.

Any party contemplating or under contract or in escrow for a transaction is urged to verify all information and to conduct their own inspections and investigations including through appropriate third-party independent professionals selected by such party. All financial data should be verified by the party including by obtaining and reading applicable documents and reports and consulting appropriate independent professionals. KW Commercial makes no warranties and/or representations regarding the veracity, completeness, or relevance of any financial data or assumptions. KW Commercial does not serve as a financial advisor to any party regarding any proposed transaction.

All data and assumptions regarding financial performance, including that used for financial modeling purposes, may differ from actual data or performance. Any estimates of market rents and/or projected rents that may be provided to a party do not necessarily mean that rents can be established at or increased to that level. Parties must evaluate any applicable contractual and governmental limitations as well as market conditions, vacancy factors and other issues in order to determine rents from or for the property. Legal questions should be discussed by the party with an attorney. Tax questions should be discussed by the party with a certified public accountant or tax attorney. Title questions should be discussed by the party with a title officer or attorney. Questions regarding the condition of the property and whether the property complies with applicable governmental requirements should be discussed by the party with appropriate engineers, architects, contractors, other consultants, and governmental agencies. All properties and services are marketed by KW Commercial in compliance with all applicable fair housing and equal opportunity laws.

KW COMMERCIAL ADVISORS

1160 Bedford Highway, Suite 100
Bedford, NS B4A 1C1



Each Office Independently Owned and Operated

PRESENTED BY:

PAUL PETTIPAS

paul.pettipas@kw.com

The calculations and data presented are deemed to be accurate, but not guaranteed. They are intended for the purpose of illustrative projections and analysis. The information provided is not intended to replace or serve as substitute for any legal, accounting, investment, real estate, tax or other professional advice, consultation or service. The user of this software should consult with a professional in the respective legal, accounting, tax or other professional area before making any decisions.