

FOR SUBLEASE

30-58 MOSHER DRIVE | DARTMOUTH - BURNSIDE BUSINESS PARK, NS

OFFICE / WAREHOUSE | 7,563 SF

kw COMMERCIAL
ADVISORSSM
A DIVISION OF KELLER WILLIAMS SELECT REALTY



LOCATION OVERVIEW

The subject property is centrally located on Mosher Drive, off Akerley Boulevard in the area of the Burnside Business Park. The location offers quick access to the Highway 111 and the MacKay Bridge to Halifax.

Burnside is the largest business park in Atlantic Canada with over 1,500 hundred enterprises and over 15,000 employees. The Park is a centrally located urban business park with superb transportation links.

PROPERTY FEATURES

- 2,000 SF built-out office/showroom
- 5,563 SF warehouse
- 2 Dock level loading doors
- 18' Clear height
- Lease expiry: January 31, 2024

SPACE AVAILABLE: 7,563 SF

LEASE RATE: \$6.25 Net & \$7.48 CAM & Tax + Utilities (Natural Gas & Electricity)

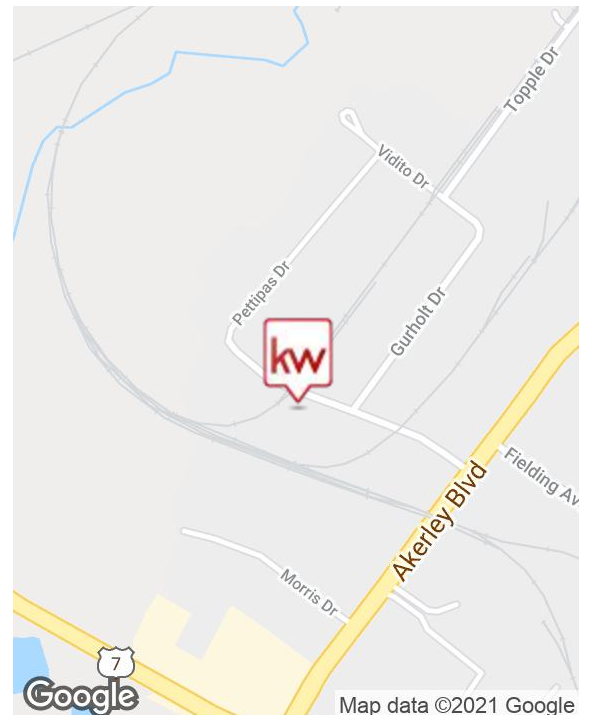

Phil Bolhuis
Real Estate Advisor
902.293.4524

philbolhuis@kwcommercial.com

Matt Olsen
Real Estate Advisor
902.489.7187

mattolsen@kwcommercial.com

KELLER WILLIAMS SELECT REALTY
1160 Bedford Highway, Suite 100
Bedford, NS B4A 1C1
www.kwcommercialhalifax.com



FOR SUBLEASE

30-58 MOSHER DRIVE | DARTMOUTH - BURNSIDE BUSINESS PARK, NS

OFFICE / WAREHOUSE | 7,563 SF

OFFICE / SHOWROOM



Phil Bolhuis
Real Estate Advisor
902.293.4524

philbolhuis@kwcommercial.com

Matt Olsen
Real Estate Advisor
902.489.7187

mattolsen@kwcommercial.com

kw COMMERCIAL
ADVISORS®



FOR SUBLEASE

30-58 MOSHER DRIVE | DARTMOUTH - BURNSIDE BUSINESS PARK, NS

OFFICE / WAREHOUSE | 7,563 SF

WAREHOUSE / EXTERIOR



Phil Bolhuis
Real Estate Advisor
902.293.4524
philbolhuis@kwcommercial.com

Matt Olsen
Real Estate Advisor
902.489.7187
mattolsen@kwcommercial.com

kw COMMERCIAL
ADVISORS®



FOR LEASE

30-58 MOSHER DRIVE | DARTMOUTH - BURNSIDE BUSINESS PARK, NS

OFFICE / WAREHOUSE | 7,563 SF

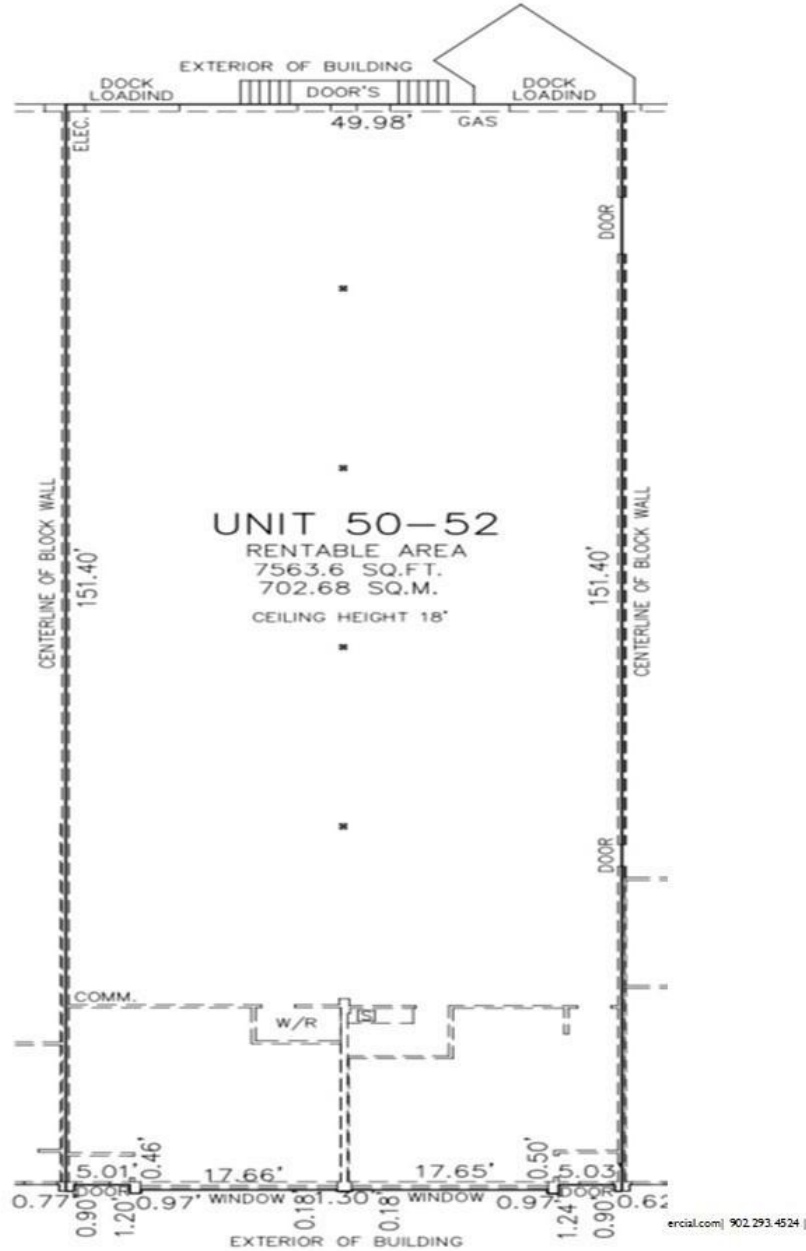

Phil Bolhuis
Real Estate Advisor
902.293.4524
philbolhuis@kwcommercial.com

Matt Olsen
Real Estate Advisor
902.489.7187
mattolsen@kwcommercial.com

kw COMMERCIAL
ADVISORS®

